

ETS 10 - CALHAS DE CLIPAGEM DIRETA L45

ETS 10 - CANALES DE CLIPAJE DIRECTO L45

SNAP-ON TRUNKINGS L45 - ETS 10

ETS 10 - GOULOTTES CLIP DIRECT L45

ETS 10 - KABELKANÄLE SNAP-IN

СЕРИЯ 10 - КОРОБ БЕЛЫЙ

100x50; 155x50; 190x50

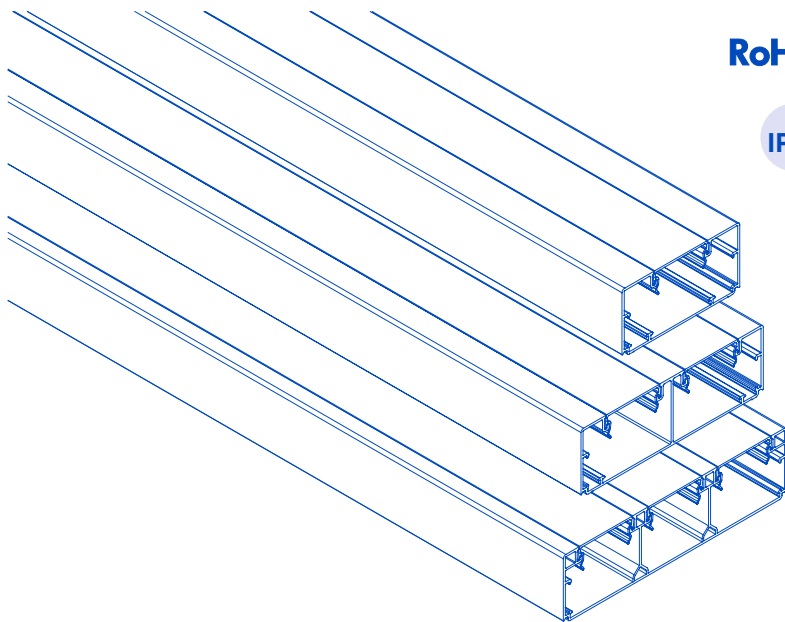

RoHS 

IP44

REF. 11020 CBR (100X50)

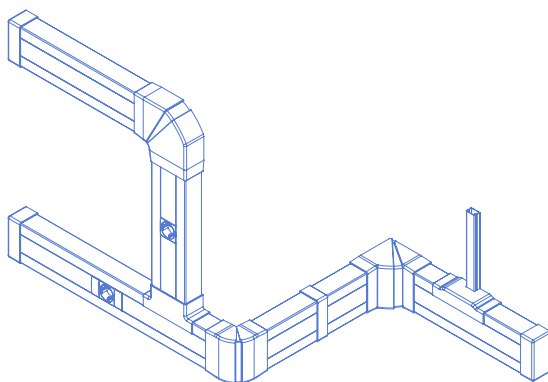

REF. 11030 CBR (155X50)

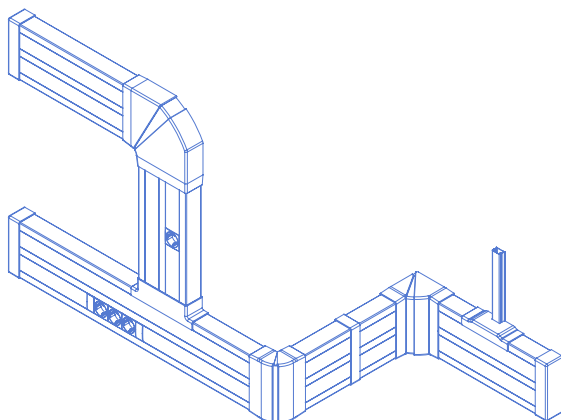

REF. 11040 CBR (190X50)

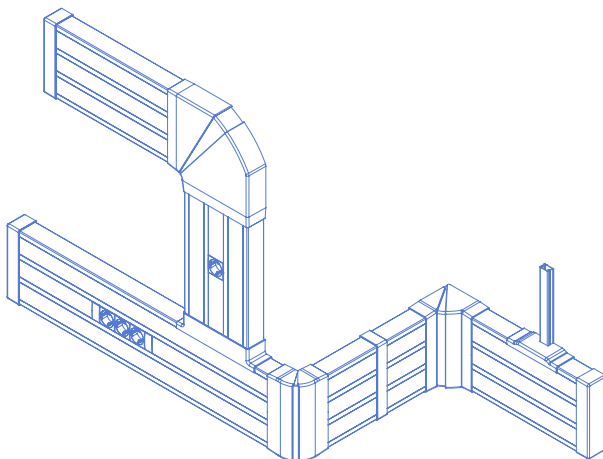

REF.	(mm)	IK
11020 CBR	100x50	08
11030 CBR	155x50	08
11040 CBR	190x50	08
ACESSÓRIOS ACCESORIOS ACCESSORIES ACCESSOIRES ZUBEHÖR АКЦЕССУАРИИ	-	07

REF. 11020 CBR | 11030 CBR | 11040 CBR

CALHA PRÉ-PUNÇIONADA | CANAL PRE AGUJEREADO | PRE-PUNCHED TRUNKING | GOULOTTE PRÉ-PERFORÉE | VORGESTANZTER KANAL | КОРОБ С РАЗМЕТКОЙ ДЛЯ ОТВЕРСТИЙ

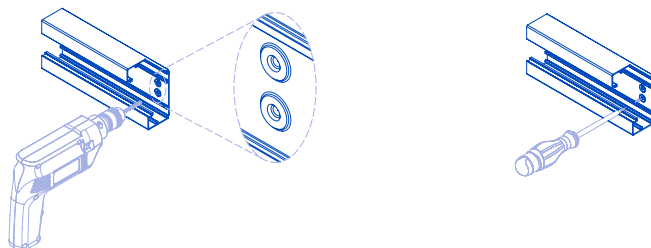

REF. 11040 CBR

ABERTURA DE DIVISÓRIA | APERTURA DE DIVISIÓN | DIVIDER OPENING | OVERTURE DE SÉPARATEUR | UNTERTEILUNG ÖFFNUNG | ОТКРЫТЬ РАЗДЕЛИТЕЛЬ

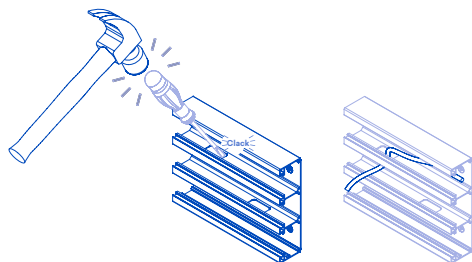

REF. 11025 ABR | 11035 ABR | 11045 ABR

DESMONTAGEM | DESMONTAJE | DISASSEMBLING | DÉMONTAGE | DEMONTAGE | РАЗБОРКА

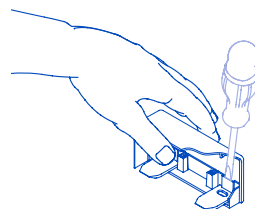

REF. 10089 R

MONTAGEM | MONTAJE | ASSEMBLING | MONTAGE | MONTAGE | МОНТАЖ

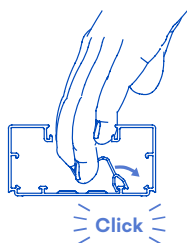

DESMONTAGEM | DESMONTAJE | DISASSEMBLING | DÉMONTAGE | DEMONTAGE | РАЗБОРКА

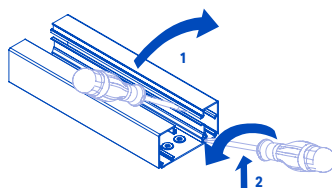

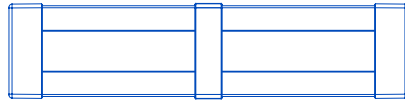

①

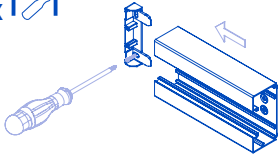

②

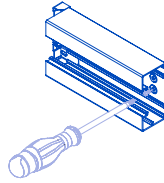

③

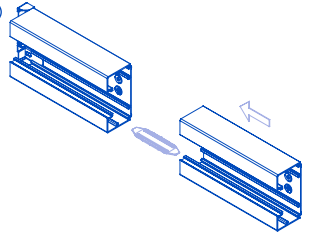

④

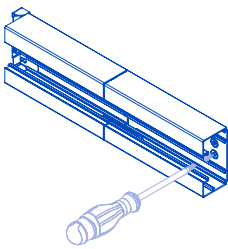

⑤

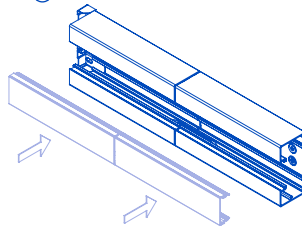

⑥

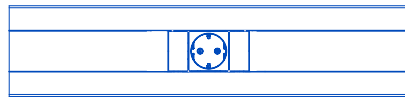
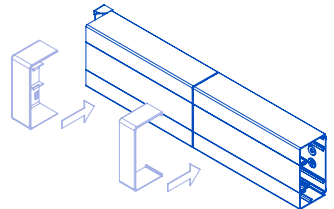

①

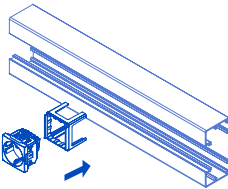

②

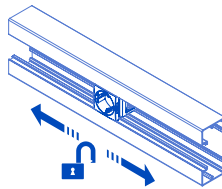

③

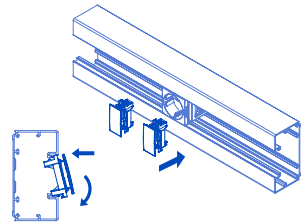

④

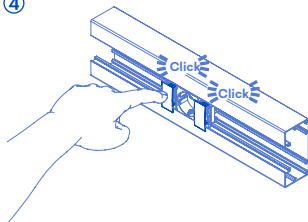

⑤

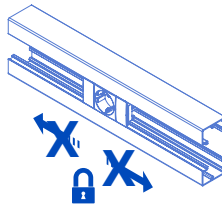



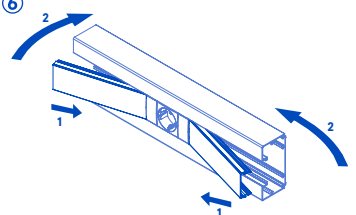

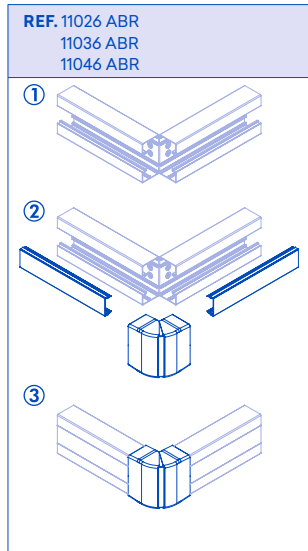
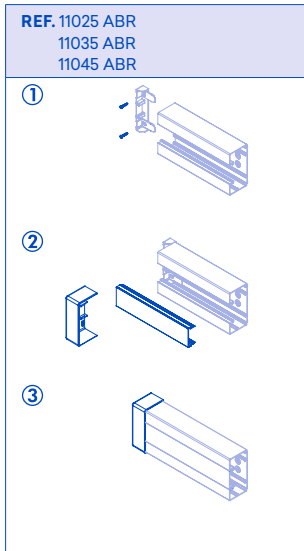
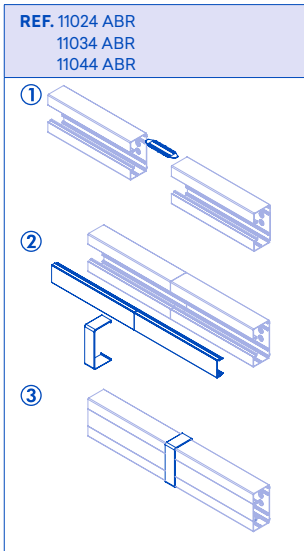
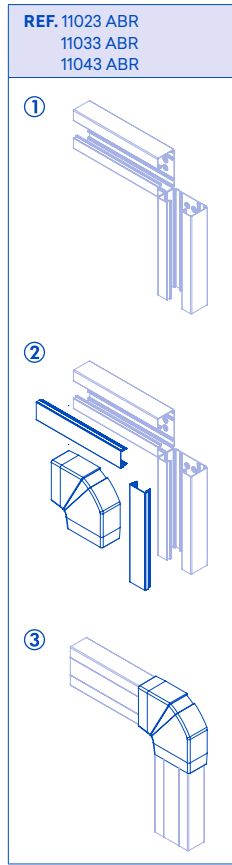
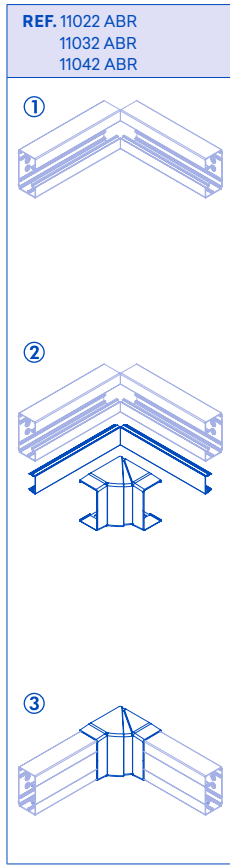
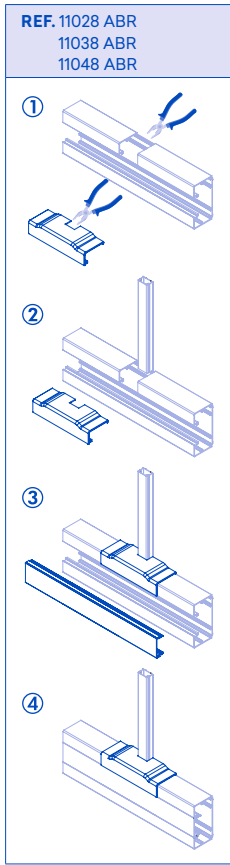
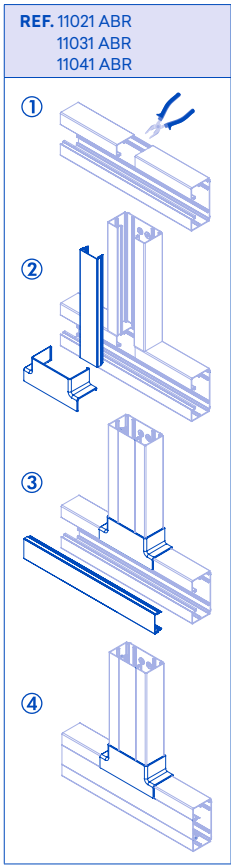

⑥





SECÇÃO 6	CLASSIFICAÇÃO	ETS 10 - CALHAS DE CLIPAGEM DIRETA L45		
6.2	Resistência ao choque para instalação e aplicação	CALHA COM ACESSÓRIOS		
		2 J		
6.3	Temperatura mínima de stock e transporte	-45 °C		
6.3	Temperatura mínima de instalação e utilização	-15 °C		
6.3	Temperatura máxima de utilização	60 °C		
6.4	Resistência de propagação da chama	Não propagador de chama		
6.5	Continuidade elétrica	Sem continuidade elétrica		
6.6	Características de isolamento elétrica	Com isolamento elétrico		
6.7	Grau de proteção dado pelo invólucro	IP44		
6.8	Proteção contra substâncias corrosivas ou poluentes	Com média proteção no exterior e no interior		
6.9	Sistema de acesso à retenção da tampa	A tampa só pode ser aberta com uma ferramenta		
6.10	Separação de proteção elétrica	Com separação de proteção elétrica (divisória)		
6.101	Posições de instalação previstas	Saliente, fixa à parede ou ao teto		
6.102	Prevenção no contacto, entre líquidos e condutores isolados e partes ativas, no caso de calhas com montagem em posição de rodapé em chão molhado.	Não declarado		
6.103	Tipo	3 (Instalação)		
	Ensaio de fio incandescente	CALHA	ACESSÓRIOS DE CALHA (derivação, ângulos, junta e topo)	ACESSÓRIOS DO SISTEMA (componente com função suplementar ex: tomadas e seus acessórios de fixação)
		1000 °C	1000 °C	650 °C
	Tensão Nominal Declarada	1000 V ~		
	IEC 60884-1 – NP 1260 Fixação de Aparelhagem de Baixa Tensão - Ensaio de Resistência à Extração	Força de Extração Declarada: 90 N 1,5x90 = 135 N		

		CARACTERÍSTICAS DAS CALHAS				CAPACIDADE DE CABOS ISOLADOS					
		Dimensões Interiores	Comp.	Secção Interior (S)	Secção Útil (Su)	ø Útil Máx.	N.º Máx. Condutores H07 V-U				
		(mm)	(m)	(mm ²)	(S/1,4) (mm ²)		(mm)	1,5mm ²	2,5mm ²	4mm ²	6mm ²
100x50	11020 CBR		2,00	2155	1539	32	191	135	106	81	
				---	① 493 ② 1058 ③ 493	① 352 ② 756 ③ 352	20 32 20	43 94 43	31 66 31	24 52 24	18 40 18
155x50	11030 CBR		2,00	① 1672 ② 1672	① 1194 ② 1194	32 32	148 148	105 105	82 82	63 63	
				---	① 357 ② 1259 ③ 1259 ④ 357	① 255 ② 899 ③ 899 ④ 255	16 32 32 16	31 111 111 31	22 79 79 22	17 61 61 17	13 47 47 13
190x50	11040 CBR		2,00	① 1325 ② 1214	① 946 ② 867	32 32	117 107	83 76	65 59	50 45	
				---	③ 1325	③ 946	32	117	83	65	50
				---	---	---	---	---	---	---	---



RoHS - Todas as Calhas e respetivos Acessórios EFAPEL satisfazem as especificações da Diretiva RoHS 2011/65/UE (incluindo a adenda 2015/863) que restringe a utilização de substâncias ou preparações perigosas, contendo chumbo, mercúrio, cádmio, cromo hexavalente, bifenilos polibromados (PBB), éteres difenilicos polibromados (PBDE), ftalato de bis(2-etil-hexilo) (DEHP), ftalato de benzilo e butilo (BBP), ftalato de dibutilo (DBP) e ou ftalato de di-isobutilo (DIBP).

SECCIÓN 6	CLASIFICACIÓN	ETS 10 - CANALES DE CLIPAJE DIRECTO L45		
6.2	Resistencia al impacto durante la instalación y uso	CANALES CON ACCESORIOS		
		2 J		
6.3	Temperatura mínima de transporte y almacenamiento	-45 °C		
6.3	Temperatura mínima de instalación y de uso	-15 °C		
6.3	Temperatura máxima de utilización	60 °C		
6.4	Resistencia a la propagación de la llama	No propagador de la llama		
6.5	Continuidad eléctrica	Sin continuidad eléctrica		
6.6	Características de aislación eléctrica	Con aislamiento eléctrico		
6.7	Grado de protección dado por envoltura	IP44		
6.8	Protección contra sustancias corrosivas o poluentes	Medianamente protegidos en el exterior y en el interior		
6.9	Sistema de acceso y retención de la tapa	La tapa sólo puede ser abierta con una herramienta		
6.10	Separación y protección eléctrica	Con separadores de protección eléctrica (división)		
6.101	Posiciones de instalación previstas	Montaje superficial en paredes o en techos		
6.102	Prevención del contacto entre líquidos y conductores aislados y partes activas para el caso de canales montados en zócalos o en el suelo humedecido con productos químicos.	No declarado		
6.103	Tipo	3 (Instalación)		
	Ensayo de hilo incandescente	CANAL	ACCESORIOS DE CANAL (derivación, ángulos, junta y tope)	ACCESORIOS DO SISTEMA (componentes con una función adicional, por ejemplo, tomas y sus accesorios)
		1000 °C	1000 °C	650 °C
	Tensión Nominal	1000 V ~		
	IEC 60884-1 - NP 1260 Fijación de Aparataje de Baja Tensión - Ensayo de Resistencia a la Extracción	Fuerza de Extracción Declarada: 90 N 1,5x90 = 135 N		







		CARACTERÍSTICAS DE LOS CANALES				CAPACIDAD DE CABOS AISLADOS					
		Dimensiones Interiores	Largo	Sección Interior (S)	Sección Útil (Su)	ø Útil Máx.		N.º Máx. Conductores H07 V-U			
		(mm)	(m)	(mm ²)	(S/1,4) (mm ²)	(mm)	1,5mm ²	2,5mm ²	4mm ²	6mm ²	
100x50	11020 CBR		96x47	2,00	2155	1539	32	191	135	106	81
			---	---	① 493 ② 1058 ③ 493	① 352 ② 756 ③ 352	20 32 20	43 94 43	31 66 31	24 52 24	18 40 18
155x50	11030 CBR		75x47 75x47	2,00	① 1672 ② 1672	① 1194 ② 1194	32 32	148 148	105 105	82 82	63 63
			---	---	① 357 ② 1259 ③ 1259 ④ 357	① 255 ② 899 ③ 899 ④ 255	16 32 32 16	31 111 111 31	22 79 79 22	17 61 61 17	13 47 47 13
190x50	11040 CBR		63x47 57x47 63x47	2,00	① 1325 ② 1214 ③ 1325	① 946 ② 867 ③ 946	32 32 32	117 107 117	83 76 83	65 59 65	50 45 50



RoHS - Todos los Canales y sus respectivos Accesorios fabricados por EFAPEL satisfacen las especificaciones de la Directiva RoHS 2011/65/UE (incluyendo la enmienda 2015/863) que restringe la utilización de sustancias o compuestos peligrosos como el plomo, mercurio, cadmio, cromo hexavalente, polibromodifenileno (PBB), polibromodifeniléteres (PBDE), ftalato de bis(2-etilhexilo) (DEHP), ftalato de bencilo y butilo (BBP), ftalato de dibutilo (DBP), y ou ftalato de diisobutilo (DIBP).

EN 50085-2-1 STANDARD

SECTION 6	CLASSIFICATION	SNAP-ON TRUNKINGS L45 - 10 ETS		
6.2	Resistance to impact for installation and application	TRUNKINGS WITH ACCESSOIRES		
		2 J		
6.3	Minimum storage and transport temperature	-45 °C		
6.3	Minimum installation and application temperature	-15 °C		
6.3	Maximum application temperature	60 °C		
6.4	Resistance to flame propagation	Non-flame propagating		
6.5	Electrical continuity	Without electrical continuity		
6.6	Electrical insulation characteristic	With electrical insulation		
6.7	Protection degree provided by enclosure	IP44		
6.8	Protection against corrosive or polluting substances	With medium protection outside and inside		
6.9	Access system and retention of the cover	The cover can only be removed with a tool		
6.10	Electrical protective separation	With electrical protective partition (divider)		
6.101	Intended installation positions	Surface mounted fixed on the wall or on the ceiling		
6.102	Prevention of contact between liquids and insulated conductors and live parts in case of mounted in a skirting position and on wet floor.	Not declared		
6.103	Type	3 (Installation)		
	Glow wire test	TRUNK-ING	TRUNKING ACCESSORIES (derivation, angles, joint and top)	SYSTEM ACCESSORIES (component with supplementary function e.g. sockets and their fixing accessories)
		1000 °C	1000 °C	650 °C
	Rated Voltage	1000 V ~		
	IEC 60884-1 – NP 1260 Fixation of Low Voltage Devices - Test of Resistance to Extraction	Declared Extraction Force: 90 N 1,5x90 = 135 N		







		TRUNKINGS CHARACTERISTICS				ISOLATED CABLES CAPACITY					
		Internal Dimensions	Length	Section Internal (S)	Section Available (Sa)	ø Available Max.	Max. Nr. Conductors H07 V-U				
		(mm)	(m)	(mm ²)	(S/1,4) (mm ²)	(mm)	1,5mm ²	2,5mm ²	4mm ²	6mm ²	
100x50	11020 CBR		96x47	2,00	2155	1539	32	191	135	106	81
			---	---	① 493 ② 1058 ③ 493	① 352 ② 756 ③ 352	20 32 20	43 94 43	31 66 31	24 52 24	18 40 18
			75x47 75x47	2,00	① 1672 ② 1672	① 1194 ② 1194	32 32	148 148	105 105	82 82	63 63
155x50	11030 CBR		---	---	① 357 ② 1259 ③ 1259 ④ 357	① 255 ② 899 ③ 899 ④ 255	16 32 32 16	31 111 111 31	22 79 79 22	17 61 61 17	13 47 47 13
			---	---	---	---	---	---	---	---	---
			63x47 57x47 63x47	2,00	① 1325 ② 1214 ③ 1325	① 946 ② 867 ③ 946	32 32 32	117 107 117	83 76 83	65 59 65	50 45 50



RoHS - All the Cable-trunkings and the respective Accessories manufactured by EFAPEL are according the specifications of Directive RoHS 2011/65/EU (including the addendum 2015/863) that restricts the use of certain hazardous substances like lead, mercury, cadmium, hexavalent chromium, polybrominated biphenyls (PBB), polybrominated diphenyl ethers (PBDE), Bis (2-ethylhexyl) phthalate (DEHP), butyl benzyl phthalate (BBP), dibutyl phthalate (DBP), diisobutyl phthalate (DIBP).

NORME EN 50085-2-1

SECTION 6	CLASSIFICATION	ETS 10 - GOULOTTE CLIP DIRECT L45		
6.2	Résistance aux chocs pendant l'installation et l'usage	GOULOTTES AVEC ACCESSOIRES		
		2 J		
6.3	Température minimale de stockage et de transport	-45 °C		
6.3	Température minimale d'installation et d'usage	-15 °C		
6.3	Température maximale d'usage	60 °C		
6.4	Résistance à la propagation de la flamme	Non propagation de la flamme		
6.5	Continuité électrique	Sans continuité électrique		
6.6	Caractéristiques d'isolation électrique	Avec isolation électrique		
6.7	Degré de protection de l'enveloppe	IP44		
6.8	Protection contre les substances corrosives ou polluantes	Avec protection moyenne à l'extérieur et l'intérieur		
6.9	Mode d'ouverture	Le couvercle peut être enlevé avec un outil		
6.10	Séparation de protection électrique	Avec séparation de protection électrique (séparateur)		
6.101	Conditions d'installation	Saillie fixé au mur ou au plafond		
6.102	Prévention de contact entre les liquides, les conducteurs isolés et les parties sous tension, dans le cas de goulottes de plinthe en plancher humide.	Non déclarée		
6.103	Type	3 (Installation)		
	Test au fil incandescent	GOULOTTE	ACCESSOIRES POUR GOULOTTES (dérivation, angles, joint et bout)	ACCESSOIRES DU SYSTÈME (composant avec fonction supplémentaire, par ex. prises et leurs accessoires de fixation)
		1000 °C	1000 °C	650 °C
	Tension Nominale Assignée	1000 V ~		
	IEC 60884-1 – NP 1260 Fixation d'Apareillage de Basse Tension - Extraction Test de Résistance	Force d'Extraction Déclarée: 90 N 1,5x90 = 135 N		

		CARACTÉRISTIQUES DES GOULOTTES				CAPACITÉ DE CÂBLES ISOLÉS					
		Dimensions Intérieures	Longueur	Section Intérieure (S)	Section Utile (Su)	ø Utile Max.	N ^{max} Max. Conducteurs H07 V-U				
		(mm)	(m)	(mm ²)	(S/1,4) (mm ²)		(mm)	1,5mm ²	2,5mm ²	4mm ²	6mm ²
100x50	11020 CBR		96x47	2,00	2155	1539	32	191	135	106	81
			---	---	① 493 ② 1058 ③ 493	① 352 ② 756 ③ 352	20 32 20	43 94 43	31 66 31	24 52 24	18 40 18
			75x47 75x47	2,00	① 1672 ② 1672	① 1194 ② 1194	32 32	148 148	105 105	82 82	63 63
155x50	11030 CBR		---	---	① 357 ② 1259 ③ 1259 ④ 357	① 255 ② 899 ③ 899 ④ 255	16 32 32 16	31 111 111 31	22 79 79 22	17 61 61 17	13 47 47 13
			63x47 57x47 63x47	2,00	① 1325 ② 1214 ③ 1325	① 946 ② 867 ③ 946	32 32 32	117 107 117	83 76 83	65 59 65	50 45 50
			---	---	---	---	---	---	---	---	---



RoHS - Toutes les Goulottes et respectifs Accessoires EFAPEL sont conformes avec la Directive RoHS 2011/65/UE (y compris l'addenda 2015/863) qui restreint l'utilisation de certain substances dangereuses comme le plomb, mercure, cadmium, chrome hexavalent, polybromobiphényles (PBB), polybromodiphényléthers (PBDE), phtalate de bis-(2-éthylhexyle) (DEHP), phtalate de benzyle et de butyle (BBP), phtalate de dibutyle (DBP), phtalate de diisobutyle (DIBP).

NORM EN 50085-2-1

SEKTION 6	KLASSIFIKATION	ETS 10 - KABELK SNAP-IN
6.2	Prüfung zur stoßfestigkeit bei einbau und anwendung	KANÄLE MIT ZUBEHÖR
		2 J
6.3	Mindesttemperatur für lager und transport	-45 °C
6.3	Mindesttemperatur für installation und nutzung	-15 °C
6.3	Höchsttemperatur für nutzung	60 °C
6.4	Flammenweiterleitung	Keine flammenweiterleitung
6.5	Elektrische kontinuierität	Keine elektrische kontinuierität
6.6	Elektrische isolierung	Mit elektrischer isolierung
6.7	Durch gehäuse sichergestellte schutzklasse	IP44
6.8	Schutz gegen korrodierende substanzen oder schadstoffe	Mit mittlerem schutz, innen und außen
6.9	Zugangsmöglichkeit der abdeckungszuhaltung	Die abdeckung kann nur mit werkzeug entfernt werden
6.10	Separierung elektrischer leiter	Mit separierung elektrischer leiter (unterteilung)
6.101	Vorgesehene einbaupositionen	Aufputz, fest an wand oder decke
6.102	Verhinderung des kontakts zwischen flüssigkeiten und isolierten leitern und unter strom stehenden teilen in als bodenleisten montierten kabelkanälen bei nassem boden.	Nicht erklärt
6.103	Typ	3 (installation)
	Glühdrahtprüfung	KANAL
		KANAL-ZUBEHÖR (Verteiler, Winkel, Verbindung und Kopfteil)
		SYSTEMZUBEHÖR (Komponente mit Zusatzfunktion, z.B. Steckdosen und deren Befestigungszubehör)
		1000 °C
		1000 °C
		650 °C
	Angegebene Nennspannung	1000 V ~
	IEC 60884-1 – NP 1260 Befestigung von Niederspannungsgeräten - Auszugsprüfung	Angegebene Auszugskraft: 90 N 1,5x90 = 135 N

		DATEN DER KABELKANÄLE				KAPAZITÄT BEI ISOLIERTEN KABELN					
		Innenmaße	Länge	Innenquerschnitt (S)	Nutzquerschnitt (Sa)	ø Máx. Nutz	Max. Anzahl Kabel H07 V-U				
		(mm)	(m)	(mm²)	(S/1,4) (mm²)	(mm)	1,5mm²	2,5mm²	4mm²	6mm²	
100x50	11020 CBR		96x47	2,00	2155	1539	32	191	135	106	81
			---	---	① 493 ② 1058 ③ 493	① 352 ② 756 ③ 352	20 32 20	43 94 43	31 66 31	24 52 24	18 40 18
			75x47 75x47	2,00	① 1672 ② 1672	① 1194 ② 1194	32 32	148 148	105 105	82 82	63 63
155x50	11030 CBR		---	---	① 357 ② 1259 ③ 1259 ④ 357	① 255 ② 899 ③ 899 ④ 255	16 32 32 16	31 111 111 31	22 79 79 22	17 61 61 17	13 47 47 13
			63x47 57x47 63x47	2,00	① 1325 ② 1214 ③ 1325	① 946 ② 867 ③ 946	32 32 32	117 107 117	83 76 83	65 59 65	50 45 50
			---	---	---	---	---	---	---	---	---



RoHS - Sämtliche EFAPEL Kabelkanäle und Zubehör entsprechen der RoHS-Richtlinie 2011/65/EU, (die Anhang 2015/863 enthalten) die Benutzung von gefährlichen Substanzen oder Zubereitungen einschränkt, die blei, quecksilber, cadmium, sechswertiges chrom, polybromierte biphenyle (PBB), polybromierte diphenylether (PBDE), di(2-ethylhexyl)phthalat (DEHP), butylbenzylphthalat (BBP), dibutylphthalat (DBP), diisobutylphthalat (DIBP).

СТАНДАРТ EN 50085-2-1

РАЗДЕЛ 6	КЛАССИФИКАЦИЯ	СЕРИЯ 10 - КОРОБ БЕЛЫЙ		
6.2	Сопrotивление механическим нагрузкам	КОРОБ С АКСЕССУАРАМИ		
		2 J		
6.3	Минимальная температура хранения и транспортировки	-45 °C		
6.3	Минимальная температура при установке и эксплуатации	-15 °C		
6.3	Максимальная температура при эксплуатации	60 °C		
6.4	Устойчивость к распространению горения	Не распространяет		
6.5	Электропроводность	Не проводит		
6.6	Электрическая изоляция	Изолирует		
6.7	Степень пыле- и влагозащиты	IP44		
6.8	Защита против коррозии и загрязнений	Средний уровень защиты снаружи и внутри		
6.9	Доступ внутрь корпуса и снятие крышки	Снятие крышки возможно только при помощи инструмента		
6.10	Разделение электрических сетей	При помощи внутренней перегородки		
6.101	Варианты установки	Накладной монтаж на стене и/или потолке		
6.102	Случаи контакта жидкости и изолированных жил кабеля в кабельных плинтусах при влажной обработке пола	Не зафиксированы		
6.103	Тип	3 (установка)		
	Тест раскаленной проволокой	КОРОБ	АКСЕССУАРЫ ДЛЯ КОРОБОВ (Отвод, углы, скобы на стык и крышка)	СИСТЕМНЫЕ АКСЕССУАРЫ (Компонент с дополнительной функцией, например розетки и аксессуары для их крепления)
		1000 °C	1000 °C	650 °C
	Номинальное напряжение	1000 V ~		
	IEC 60884-1 – NP 1260 Фиксация низковольтных устройств - Тест на устойчивость к извлечению	Сила извлечения: 90 N 1,5x90 = 135 N		

		ХАРАКТЕРИСТИКИ КАБЕЛЬНЫХ КАНАЛОВ				ДОПУСТИМОЕ КОЛИЧЕСТВО КАБЕЛЕЙ							
		Внутренние размеры	Длина	Внутреннее сечение (Bc)	Доступное сечение (Dc)	Доступный Максимальный диаметр	макс кол-во проводников H07 V-U						
		(mm)	(m)	(mm ²)	(Bc/1,4) (mm ²)	(mm)	1,5mm ²	2,5mm ²	4mm ²	6mm ²			
100x50	11020 CBR		96x47	2,00	2155	1539	32	191	135	106	81		
			—	—	① 493 ② 1058 ③ 493	① 352 ② 756 ③ 352	20 32 20	43 94 43	31 66 31	24 52 24	18 40 18		
155x50	11030 CBR		75x47	2,00	1672	1194	32	148	105	82	63		
			75x47				① 1672 ② 1672	① 1194 ② 1194	32	148	105	82	63
190x50	11040 CBR		63x47	2,00	1325	946	32	117	83	65	50		
			57x47				① 1325 ② 1259 ③ 1259 ④ 357	① 255 ② 899 ③ 899 ④ 255	32 32 32 16	111 111 79 31	79 79 61 22	61 61 47 17	47 47 47 13
			63x47				① 1325 ② 1214 ③ 1325	① 946 ② 867 ③ 946	32 32 32	117 107 117	83 76 83	65 59 65	50 45 50
			63x47				① 1325 ② 1214 ③ 1325	① 946 ② 867 ③ 946	32 32 32	117 107 117	83 76 83	65 59 65	50 45 50



RoHS - все кабельные корпуса и аксессуары к ним, производимые компанией EFAPEL, полностью соответствуют требованиям Директивы RoHS 2011/65/EC (включая приложение 2015/863), которая ограничивает использование ряда опасных веществ, таких как свинец, ртуть, кадмий, шестивалентный хром, полибромированные бифенилы (ПВВ), полибромированные дифениловые эфиры (ПВДЕ), бис (2-этилгексил) фталат (ДЕНП), бутилбензилфталат (ББП), дибутилфталат (ДБП), диизобутилфталат (ДИБП).



A EFAPEL reserva o direito de modificar este documento ou os produtos nele contidos sem aviso prévio. Em caso de dúvida, contacte a EFAPEL.

EFAPEL se reserva el derecho de modificar este documento o los productos contenidos en él sin previo aviso. En caso de dudas, por favor póngase en contacto con EFAPEL.

EFAPEL reserves the right to modify this document or the products contained in it without notice. If in doubt please contact EFAPEL.

EFAPEL se réserve le droit de modifier ce document ou les produits ci-inclus sans préavis. En cas de doute, veuillez contacter EFAPEL.

EFAPEL behält sich das Recht vor, dieses Dokument oder die darin enthaltenen Produkte ohne vorherige Ankündigung zu ändern. Im Zweifelsfall kontaktieren Sie bitte EFAPEL.

Компания EFAPEL оставляет за собой право изменять данный документ или описываемые им продукты без предупреждения. Если у вас появились сомнения, свяжитесь с нами.