

**DESCRIPTION**

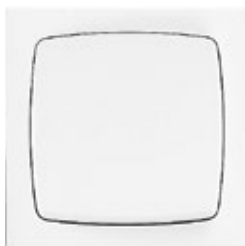

- Products in technical thermoplastic - resistant material, non-conductive.
- Available in White (RAL 9003), the same used in EFAPEL Cable Trunkings.
- Product sold in semi-assembled form.

**CHARACTERISTICS**

- Mechanisms in technical thermoplastic - resistant material, non-conductive.
- For installations in surface mounting applications and/or installations with Technical Cable Trunkings.
- Control Devices
  - 10 A - 250 V~ - connections with screw terminals. It allows the usage of rigid and flexible cable.
  - Pilot Light.
  - In accordance with IEC/EN 60669-1 Standard, tested according to 19.3:

Relationship between rated current of the switch and rated power of the SBL circuit	
Rated current of the switch, In [A]	Rated power of the SBL circuit [W]
$I_n \leq 10$	100
$10 < I_n \leq 13$	150
$13 < I_n \leq 16$	200
$16 < I_n \leq 20$	250

SBL - Self Ballasted Lamp (CFL or LED)

- Energy Sockets
  - Earth Socket (Schuko and French types):
    - 16 A - 250 V~.
    - Connections with screw terminals or screwless terminals.
    - Available in colors White, Red and Orange.
    - In accordance with IEC 60884-1; DIN VDE 0620-1 (Schuko) and NF C 61-314 (French) Standards.
- Variety of Functions: Control Devices; Electrical Blinds Control; Energy Sockets; Radio, Television and Satellite Sockets; Telephone Sockets; Data Sockets; etc...
- Adaptable to all 10 Series Cable Trunkings - Mini Cable using the lateral adapter for each of the cable trunkings.

**DIMENSIONS (mm)**

**SWITCH WITH BOX**

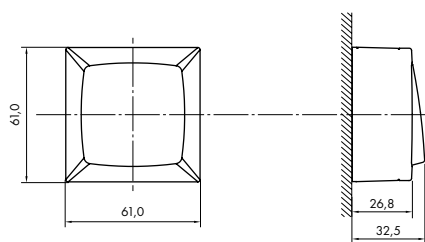

**ENERGY SOCKETS WITH BOX**

